

FOR RELEASE

Aug. 27, 2024

**Opened 4SSTAY(Fourth stay) in Takamatsu,stay in the town as if you live there.
The best inn for touring around Shikoku**



Takamatsu, Aug. 27,2024/Shikoku Railway Co,Ltd./ – Shikoku Railway Company will open “4S STAY,” a simple lodging facility based on the concept of “stay as you live” in Takamatsu City, Kagawa Prefecture (an 11-minute walk from Takamatsu Station), on November 14, 2024. information on 4S STAY is available on the Internet at “<https://4s-stay.com/takamatsu/>.”

Since 2018, Shikoku Railway Company has been developing simple lodging facilities utilizing vacant houses and old private homes as a new proposal for diversifying travel styles against a backdrop of strong inbound demand. So far, the company has opened three “4S STAY” guesthouses in Ikeda-cho, Miyoshi City, Tokushima Prefecture, based on the concept of “travel as if you were living there,” and has worked to revitalize the local community using guesthouses as a base. Next, a 54-year-old traditional Japanese house will be renovated and opened as an inn “Setolive by 4S STAY. By continuing to develop lodgings in Shikoku that make use of vacant

and old houses, which are becoming a social issue, we will offer a new style of lodging to people in Japan and abroad that takes advantage of Shikoku's abundant nature, including the sea, mountains, rivers, and islands, thereby contributing to the revitalization of the region.

About the Facility

- Number of rooms and capacity: 5 rooms, 13 persons
- Facilities: Lounge shared with cafe, dining room with mini-kitchen. 1 Japanese-style room with garden (with private toilet/bathroom/washbasin), 2 Japanese-style rooms, 2 Western-style rooms (with private toilet/shower/basin)
- Reservations: Official website "<https://4s-stay.com/takamatsu/>" from September 12, 2024 at 10:00 a.m.
- Room rates: 18,000 yen and up per room per night including breakfast for first-floor guest rooms (with garden) (for two adults); 15,000 yen and up per room per night including breakfast for Japanese-style rooms and Western-style rooms (for two adults).
- A press preview will be held upon completion of the facility, scheduled for early November 2024.



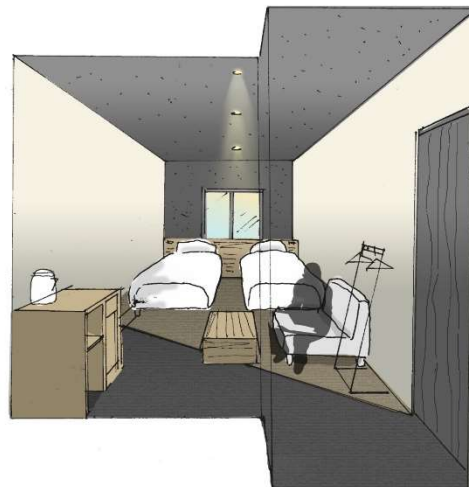
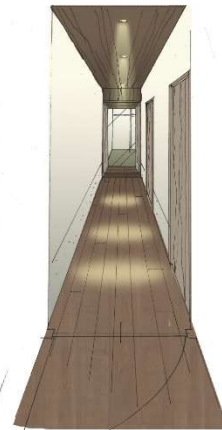

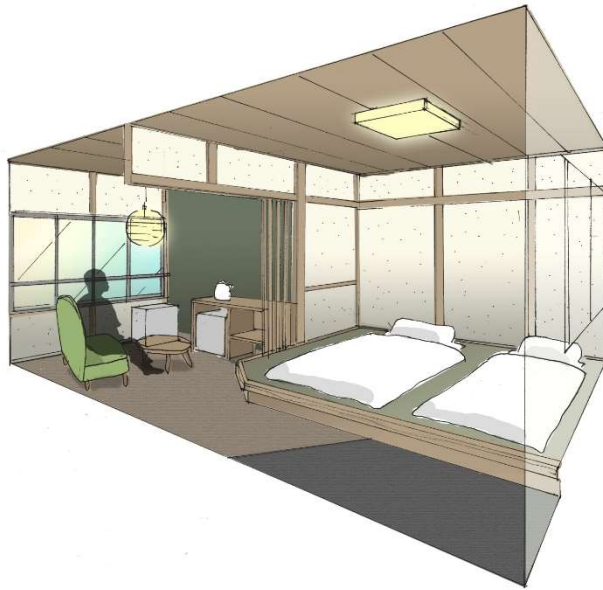

About us:Shikoku Railway Company is the main public transportation company in Shikoku. Headquartered in Takamatsu City, Kagawa Prefecture, the company was established in 1987 and operates a total of nine railroad lines, covering 853.7 km, in four prefectures of Shikoku and a part of Okayama Prefecture connected by the Seto-ohashi Line, and manages 259 railroad stations (including two temporary stations).

information on Shikoku Railway Company is available on the Internet at “<https://jr-shikoku.co.jp/>.”

Contact:

Masahiro Morita

Shikoku Railway Co.,Ltd.

Email: morita-m@jr-shikoku.co.jp

###