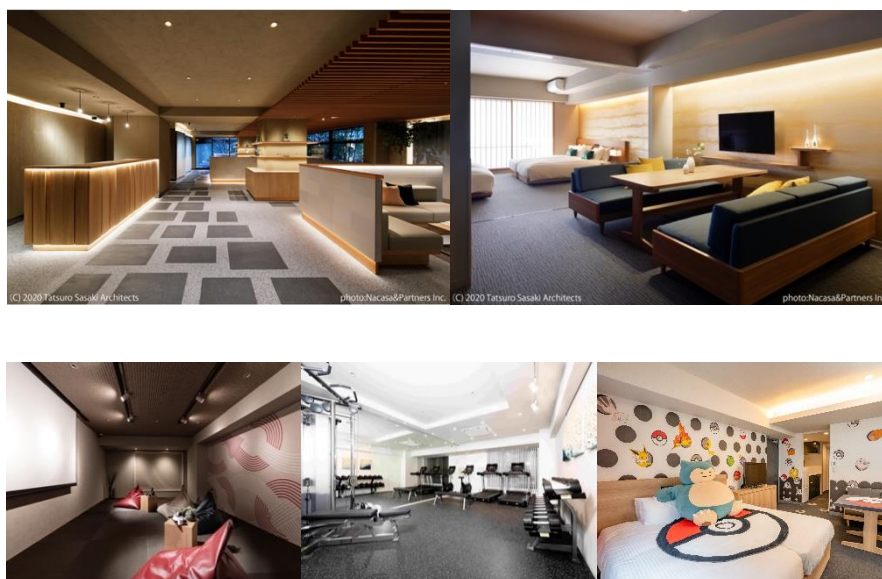

MIMARU's Largest Kyoto Facility, MIMARU Kyoto Kawaramachi Gojo, Is Set to Reopen on October 1st, Chock-Full of 10 Different Room Types (Including Pokémon Rooms) and Ample Common Space.

~Reservations for the Autumn Colors Season and New Year Period are Open! Recommended for Groups and as a Base for Your Travels~

Cosmos Hotel Management Co., Ltd. is set to reopen Apartment Hotel MIMARU Kyoto Kawaramachi Gojo, a hotel conveniently located near Kyoto Station and only a 3-minute walk from Kiyomizu Gojo Station, on October 1, 2023.

MIMARU Kyoto Kawaramachi Gojo (Official Website : <https://mimaruhotels.com/hotel/kawaramachi-gojo/>) is the largest of the 7 MIMARU hotels in Kyoto with 96 rooms. You can choose the room type that best fits your family or travel group from a wide variety, including 40m² rooms designed for families and groups (maximum capacity of 4 people), spacious 60 m² rooms (maximum capacity of 4-6 people), connecting rooms that can house up to groups of 8, or the worldwide fan-favorite Pokémon rooms. Within the hotel, you will find a fitness gym, entertainment room, and outdoor terrace to enjoy. We have also introduced a luggage storage service for before and after your stay, as well as in-between if you have multiple reservations! We support mid- to long-term stays for trips and workcations that are based in Kyoto. Reservations will go online in August 2023. Reservations for the autumn colors season are still available (as of August 31, 2023).

※In addition to the capacity of each room, up to 2 children 6 years of age or younger can share a bed with an adult.



As of June 2023, major hotels in Kyoto City have recovered to occupancy rates approximately 90% of what they were in 2019 (according to the Kyoto City Tourism Association). With the increase in flights between Kansai and the rest of Asia, China's lifting of the ban on group tours, and China's Mid-Autumn Festival and National Day, travel demand is expected to increase further. MIMARU Kyoto Kawaramachi Gojo, which will reopen in October, is located near Kyoto Station and the bustling shopping district, as well as Kawaramachi. You can also easily travel to Osaka, which is preparing for the World Expo, Shiga, which is growing in popularity as a travel destination, Nara, and other neighboring cities within an hour from this location. MIMARU's spacious guest rooms and plentiful room types that can even accommodate up to 6 to 8 adults, and which all include a living area, kitchen/dining area, and bathroom, will provide guests both from Japan and abroad with a comfortable stay in Kyoto in combination with the services and facilities convenient for mid- to long-term stays.

■ MIMARU Kyoto Kawaramachi Gojo's Standout Areas

- ① **A plentiful variety of room types, from those geared toward large groups of 6-8 people to Pokémon rooms and more.**
- ② **MIMARU's largest Kyoto hotel with well-designed common spaces for comfortable mid- to long-term stays.**
- ③ **Located conveniently near Kyoto Station and Kawaramachi. It also boasts a luggage storage service to facilitate excursions out of the city.**

■ Whether you stay for one night or for a mid- to long-term stay, this is an apartment hotel that will make your stay in Kyoto comfortable.

- 1. **A plentiful variety of room types, from those geared toward large groups of 6-8 people to Pokémon rooms and more.**

The guest rooms feature a soft design to express the subtle changes in each season's colors reflected by the Kamo River. You can choose from a wide variety of room types, including the main 40 m² rooms, two-bedroom and connecting rooms, Pokémon rooms, and more. The Pokémon rooms, which are popular with Pokémon fans around the world, not only greet you with a giant Snorlax sitting on a bed, but are also stocked with plates and cups with an original design and come with a present of Pokémon room original goods (reusable bag, luggage tag, and message card).



Pokémon Room Original Novelties
(Kansai Design)

The kitchen also has everything you need to cook, so whether you cook using Kyoto's local ingredients, take out side dishes from popular restaurants, or regularly eat out, you can enjoy your mealtimes to the fullest. Furthermore, the bathrooms come equipped with bathtubs, and there are laundry facilities to help you unwind after your long travels.



Guest Room (4 people capacity)



Guest Room (6 people capacity)



Pokémon Room (Image)



Japanese Room



Kitchen and Dining Area



Bathroom

Pokémon Room Details: <https://mimaruhotels.com/experience/stay-pokemonroom/>

©Pokémon. ©Nintendo/Creatures Inc./GAME FREAK inc.

TM, ®, and character names are trademarks of Nintendo.

2. MIMARU's largest Kyoto hotel with well-designed common spaces for comfortable mid- to long-term stays.

Tatsuro Sasaki, winner of numerous Good Design Awards and other accolades, supervised the designs for the lobby and guest rooms. The common space is furnished with a fitness gym, something in high demand among overseas guests, to allow guests to continue with any health management routines they may have. There is also an entertainment room with a large screen where you can enjoy your own videos or reserve it to use for business meetings and other events.



Entrance



Fitness Gym



Entertainment Room



Rooftop Terrace

3. Located conveniently near Kyoto Station and Kawaramachi. It also boasts a luggage storage service to facilitate excursions out of the city.

When you want to use Kyoto as a base to go sightseeing in neighboring cities, your large luggage can be a hindrance. MIMARU Kyoto Kawaramachi Gojo has a luggage storage service for before and after your stay, as well as in-between if you have two reservations in order to support any trips out of Kyoto.



Luggage Storage



APARTMENT HOTEL
MIMARU

Unlock Your Japan

■ MIMARU Kyoto Kawaramachi Gojo Overview

MIMARU Kyoto Kawaramachi Gojo is the largest MIMARU in Kyoto with 96 guest rooms. Among these rooms, there are 47 family-type rooms with two single beds and a bunk bed (40 m², maximum capacity of 4 people), 10 two-bedroom-type rooms with 4 single beds recommended for friends traveling together (60 m², maximum capacity of 4 people), 5 Japanese apartments with 2 single beds and a tatami room (45m², maximum capacity of 5 people), 4 connecting-type rooms with 4 single beds and 2 bunk beds (80 m², maximum capacity of 8 people), and more for a total of 10 different room types. This ensures you can choose a room type that suits your group, from the number of family members or friends to considerations for the ages of any children staying. It is also close to Kyoto Station, making it an ideal base for sightseeing in nearby cities such as Osaka, Nara, and Shiga. To make mid- to long-term stays more comfortable, we also have several common areas such as the fitness gym and entertainment room for guests to enjoy at their leisure.

MIMARU Kyoto Kawaramachi Gojo Facility Overview

Address: 17-1 Hirai-cho, Nishitakasegawa-suji Gojoshitaru, Shimogyo-ku,
Kyoto-shi

Access: A 3-minute walk from Kiyomizu Gojo Station (Keihan Main Line)

A 9-minute walk from Gojo Station (Karasuma Metro Line)

Facilities: 5 stories (above-ground), 96 guest rooms, fitness gym,
entertainment room, laundry room

Reopening: Sunday, October 1, 2023

※Originally opened on February 6, 2020, temporarily closed from April 20, 2020

Official Website: <https://mimaruhotels.com/hotel/kawaramachi-gojo/>

News Release from the Original Opening (for reference):

<https://www.cigr.co.jp/newsrelease/news/2020/02/kawaramachi-gojo.html>



Exterior View

| About Cosmos Hotel Management | (Head office: Tokyo, Minato, President: Hideki Fujioka)

Cosmos Hotel Management operates APARTMENT HOTEL MIMARU, an apartment hotel catered to large groups of travelers, where everyone can stay together in a spacious, comfortable room.

Enjoy a relaxing trip with family and friends in our rooms that start at 40 square meters and are equipped with fully furnished kitchens and dining spaces. Open the door to a new Japan and broaden your horizon with exciting discoveries. Create truly special experiences with the help of our Japan-loving staff and enjoy a trip that is undoubtedly "you". This is encompassed in MIMARU's tagline "Unlock Your Japan".

Sustainability: From people to society, connecting to the future with joy. At our company, through the three themes of the diversity of people and work styles, the connection between guests and local communities, and environmental impact, we are aiming for a society where the connection of happiness spreads from our guests to the region and from the region to the world, now into the future. We will continue to take steady steps toward achieving the SDGs.

MIMARU Official Website : <https://mimaruhotels.com/>

Sustainability webpage : <https://mimaruhotels.com/sustainability/>



Contact:

Cosmos Hotel Management Co., Ltd.

5-34-6 Shiba, Minato-ku, Tokyo, Japan 108-8416

Email: info-pr@chm.cigr.co.jp



APARTMENT HOTEL
MIMARU

Unlock Your Japan

